

CELL

CENTER OF EXCELLENCE IN
LEADERSHIP OF LEARNING

UNIVERSITY OF INDIANAPOLIS

RIGOR IN TIMED WRITES

Presenters:

Alyssa Howe

English & Communication Teacher
Perry Central Jr.-Sr. High School

INDIANA EARLY
COLLEGE SUMMIT

Why Timed Writes?



Reduces cheating
Prepares them for the
AP Exam
Prepares them for
college



Revision
process: 1st
Draft Thinking
and 2nd Draft
Crafting

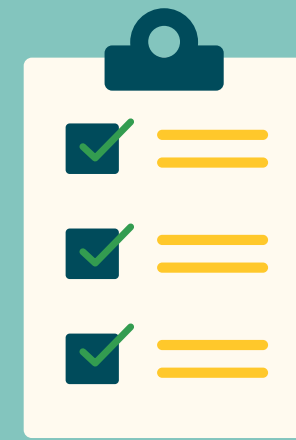

Student agency:
Goal setting and
progress
tracking

Rigor in Timed Writes

1

Setting up a locked
Google Form

2

Timed Write
Example & Process

3

Templates and
Highlighting

4

Grading and
Tracking System



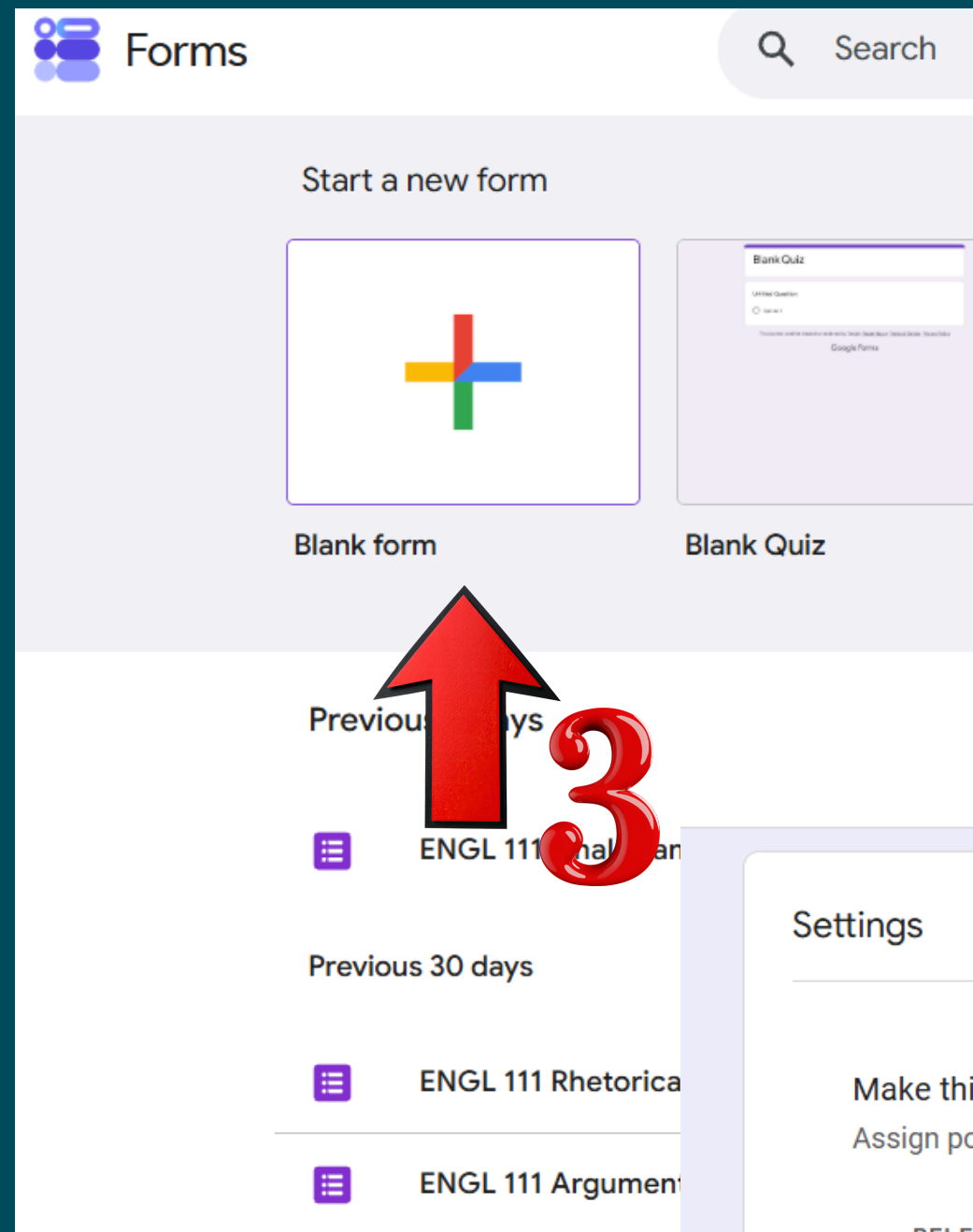
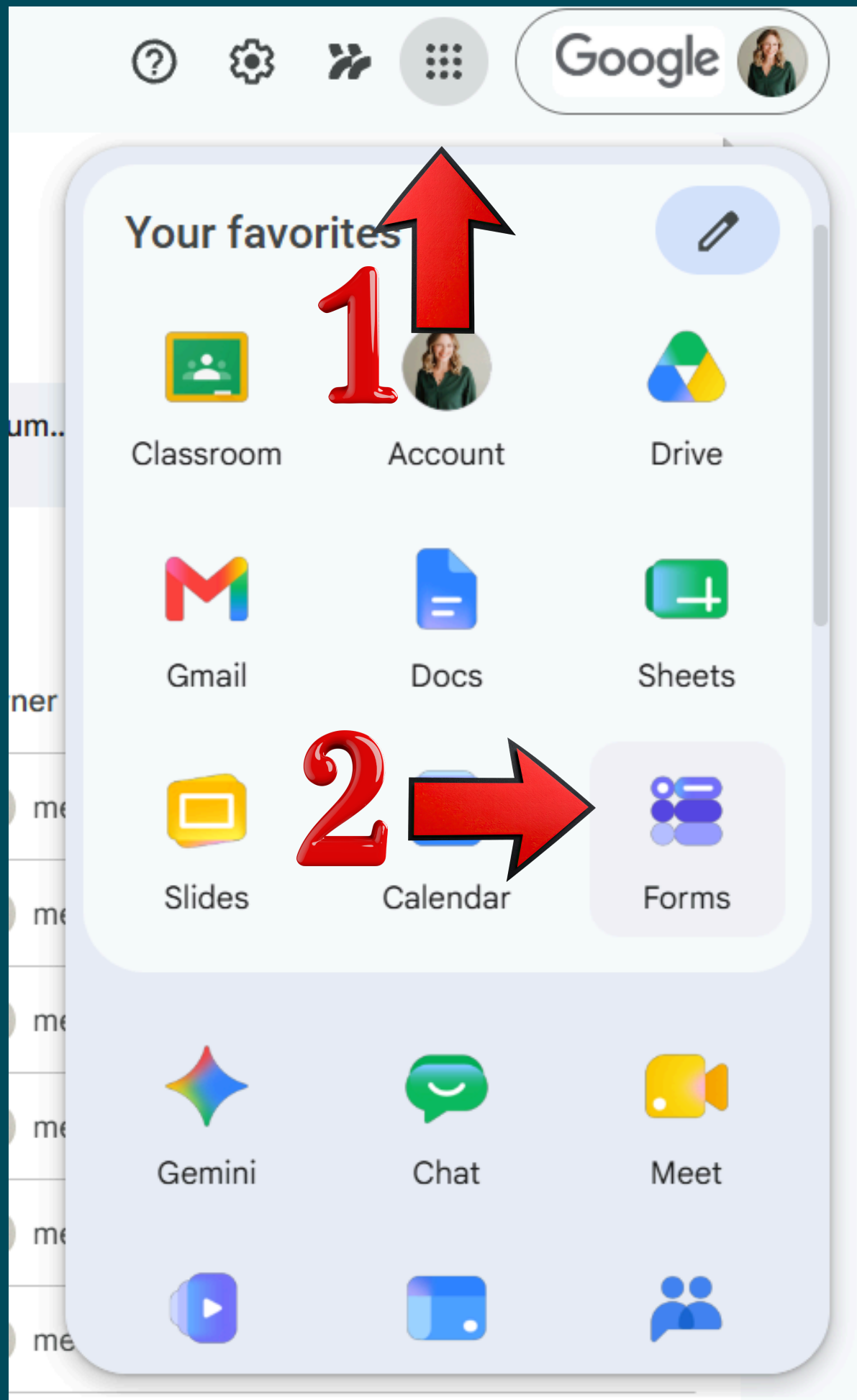

1. Google Waffle Icon
2. Forms
3. Blank Form
4. Settings
5. Switch to Quiz and Locked Mode

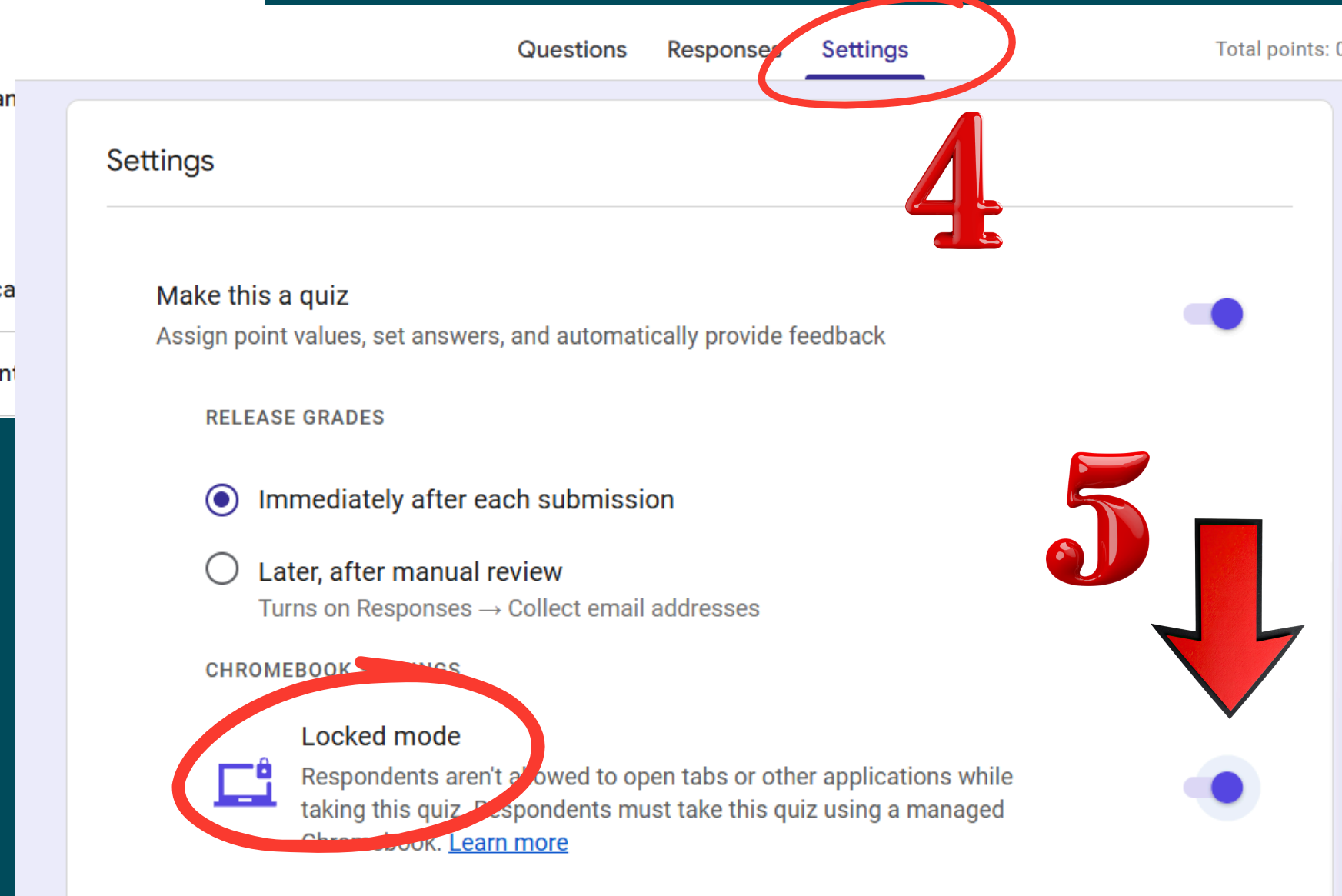

ENGL 111 Rhetorical Analysis #6

Directions: Read the **AP prompt** [provided in class](#). Determine purpose and the rhetorical strategies employed to accomplish that purpose. Then, craft a rhetorical analysis in the form of a **thesis statement and two body paragraphs**. Your score is defined by the **AP Language and Composition rubric**.



Locked mode is on. Only respondents using managed Chromebooks can open this quiz.

[Remove](#)

This form is automatically collecting emails from all respondents. [Change settings](#)

First and Last Name *

Short answer text

Please use this space to type your thesis statement and two body paragraphs: *

Long answer text

Need a rigorous prompt?

AP College Board posts recent exam prompts on their [public page](#). You do not need College Board access to retrieve them.

- I recently used the 2025 Rhetorical Analysis prompt from Question Set 1:

2. The following is a passage from the introduction to David Treuer’s 2012 nonfiction book *Rez Life: An Indian’s Journey Through Reservation Life*. Treuer is a member of the Leech Lake Band of Ojibwe, a tribal nation in Minnesota. In *Rez Life*, Treuer draws on research and personal experience to explore the history of reservations and the issues that affect Native Americans who live on them today. A reservation is an area of land governed by a tribal nation in what is now the United States. Read the passage carefully. Write an essay that analyzes the rhetorical choices Treuer makes to develop his argument about the contributions that Native Americans and their communities have made to the United States.

In your response you should do the following:

- Respond to the prompt with a thesis that analyzes the writer’s rhetorical choices.
- Select and use evidence to support your line of reasoning.
- Explain how the evidence supports your line of reasoning.
- Demonstrate an understanding of the rhetorical situation.
- Use appropriate grammar and punctuation in communicating your argument.

Par.
1

[T]he sign reads: WELCOME TO THE LEECH LAKE INDIAN RESERVATION HOME OF THE LEECH LAKE BAND OF OJIBWE PLEASE KEEP OUR ENVIRONMENT CLEAN, PROTECT OUR NATURAL RESOURCES NO SPECIAL LICENCES REQUIRED FOR HUNTING, FISHING, OR

The Process



1. Locked Google Form must be open *before* they receive the prompt / question
2. Prompts vary by class period
3. Binder of resources is allowed
4. 45 minutes to answer the prompt
 - a. They **MUST** write the entire time
5. Students hit “submit” at the bell
 - a. IEP students get their extended time for the scored revisions
6. I PRINT and students HIGHLIGHT
7. An initial score and feedback is provided
8. They record that score in their progress tracker
9. Handwritten revisions are allowed
10. Updated scores are entered in the tracker as well
 - a. All copies are stored in the binder

Resources

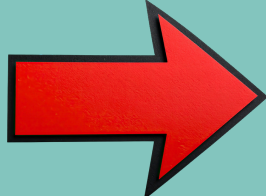

1. Rubric
2. Worksheets
3. Sample 

SIXTH PERIOD EXAMPLE

In the 9/11 address, the President of the United States, George W. Bush, alludes to the Bible and Christianity and employs metaphors to remind civilians of America's resilience, ultimately leading the American people to feel united and safe.

President Bush quotes the Bible and refers to Christian practices to unite the American people and make them feel safe. In one of the final paragraphs of his speech, he calls upon the prayers and sympathy of all Americans, pulling from religious influence to help his cause. He presents a Bible verse about tough times, saying, "Even though I walk through the valley of the shadow of death, I fear no evil for you are with me." America, as a very religious country, feels a great deal of security in its faith, so by referencing the Bible, he is invoking that feeling of security. This mention of religion helps people to trust in their faith that everything will turn out okay. Having a belief in a higher entity provides a feeling of being in control, which provides a sense of relief and security. He also assures people by asking for prayers for everyone affected. "Tonight, I ask for your prayers for all those who grieve... and I pray they will be comforted by a Power greater than any of us." Again, by referencing a common Christian practice, asking for prayers during tough times, he exemplifies empathy and provides the security that comes with familiarity. By implying these qualities through his speech, he instills a sense of safety in the American people. Not only this, but having a leader who trusts in God gives a good example to the worried Americans that God can comfort and have control, which assures Americans that they are safe. By referencing the Bible and religious practices, President Bush assures the people and makes them feel safe.

So what does the work look like?

Please use this space to type your thesis statement and two body paragraphs: *

/ 0

In the introduction of his book, David Treuer uses contrast and allusions to American culture and history to prove to his American readers how instrumental the contributions of Indian people are to the US, ultimately leading the reader to feel shocked.

Treuer uses contrast to show how despite how much room they take up in the American conscience and land, the impact they have made on the US is huge, making the reader feel shocked. He starts with the inscription of a native reserve sign, describing what life is like on either side of the sign. The lands are the same, the houses aren't that different, but the children "do look different," and the cars, "most of them, seem older." This is the first of many comparisons. This isn't unusual as to how the average American thinks of a reservation and its people. Most people think of them as relatively small, and slightly poorer. However, this familiarity is contrasted as he begins describing how the many tribes and reservations differ. Some are big, some are small, some are bigger than states. Some reservations are wealthy. His point about Native American influence is proven as he leads into the Seminole, who bought the Hard Rock Cafe. Most people can recognize that name, and would be surprised that it is officially owned by a reservation. This is followed by the Oneida, who's group renovated a football field, on which a football player with Native American blood played. This contrast from the beginning of the paragraph where the information felt familiar to the bottom where the reservation's economic accomplishments were displayed allows Treuer to shock the reader from what they thought they knew about reserves.

David Treuer also uses allusions to American culture and history to prove a point about just how instrumental Native Americans are--and were--to the US. In one line, he makes the comparison that Indian reservations (and the people who live there) "are as American as apple pie, baseball, and muscle cars." These references are intentional, as all three--apple pie, baseball, and muscle cars--have strong connotations with American culture. Any American reader would recognize that immediately, proving his point that Native Americans are key--an

Revision



What can't they do? : Change their thesis/ original argument.

Narrowly focus evidence

Students can make evidence more specific (usually with arguments).

Expand explanations / elaborations

They can explain their evidence more thoroughly or expand their elaborations and how their evidence proves their thesis.

Fix grammar and mechanics

Speed does not usually equal proper grammar or spelling - in fact, locked Google Forms do not allow for Grammarly. So they are usually a hot mess express.

Goal Setting & Tracking

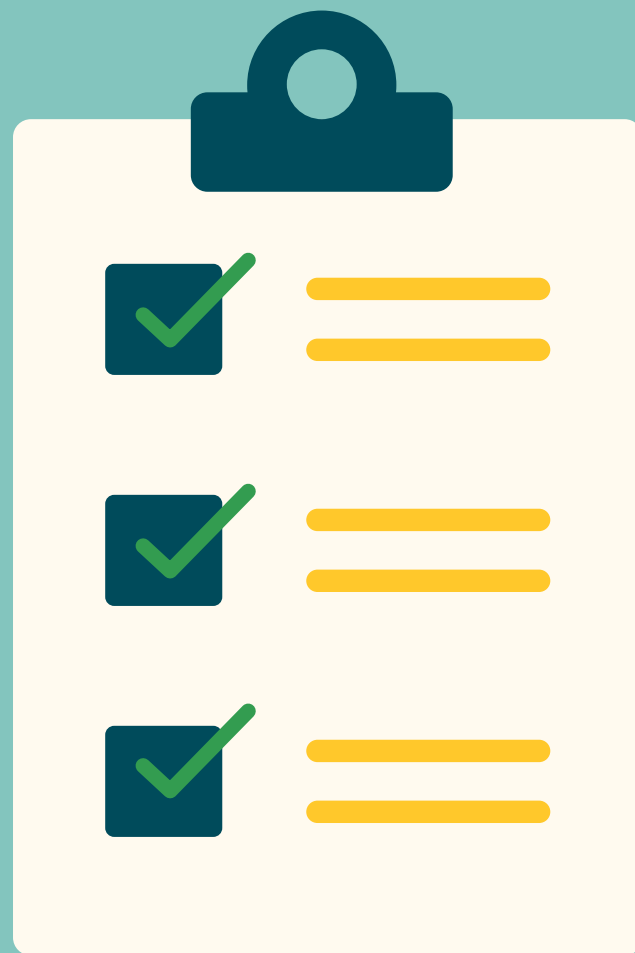

Progress Tracker

Students have a paper copy of the linked progress tracker to track rubric scores, goals for next time, and any revision scores.

Setting Goals

Students are required to set goals to push themselves and get better every time. They are also encouraged to set additional goals for themselves from a list I provide.

Reflection

Students also must reflect on the work itself after they receive it and it is stored in their binder.

There are quarterly and end-of-year reflection requirements as well.

So, how do I grade all of this?

Goal 1 Objective of ENGL 111
and AP Lang (50 points)

Quarterly Expectations:

Consistent Scores (Timed or Revised)

Quarter 1: 3/6

Quarter 2: 4/6

Quarter 3: 5/6

Quarter 4: 6/6



CELL

CENTER OF EXCELLENCE IN
LEADERSHIP OF LEARNING

UNIVERSITY OF INDIANAPOLIS

SURVEY REMINDER

Please complete a survey in Sched
for each session you attend.

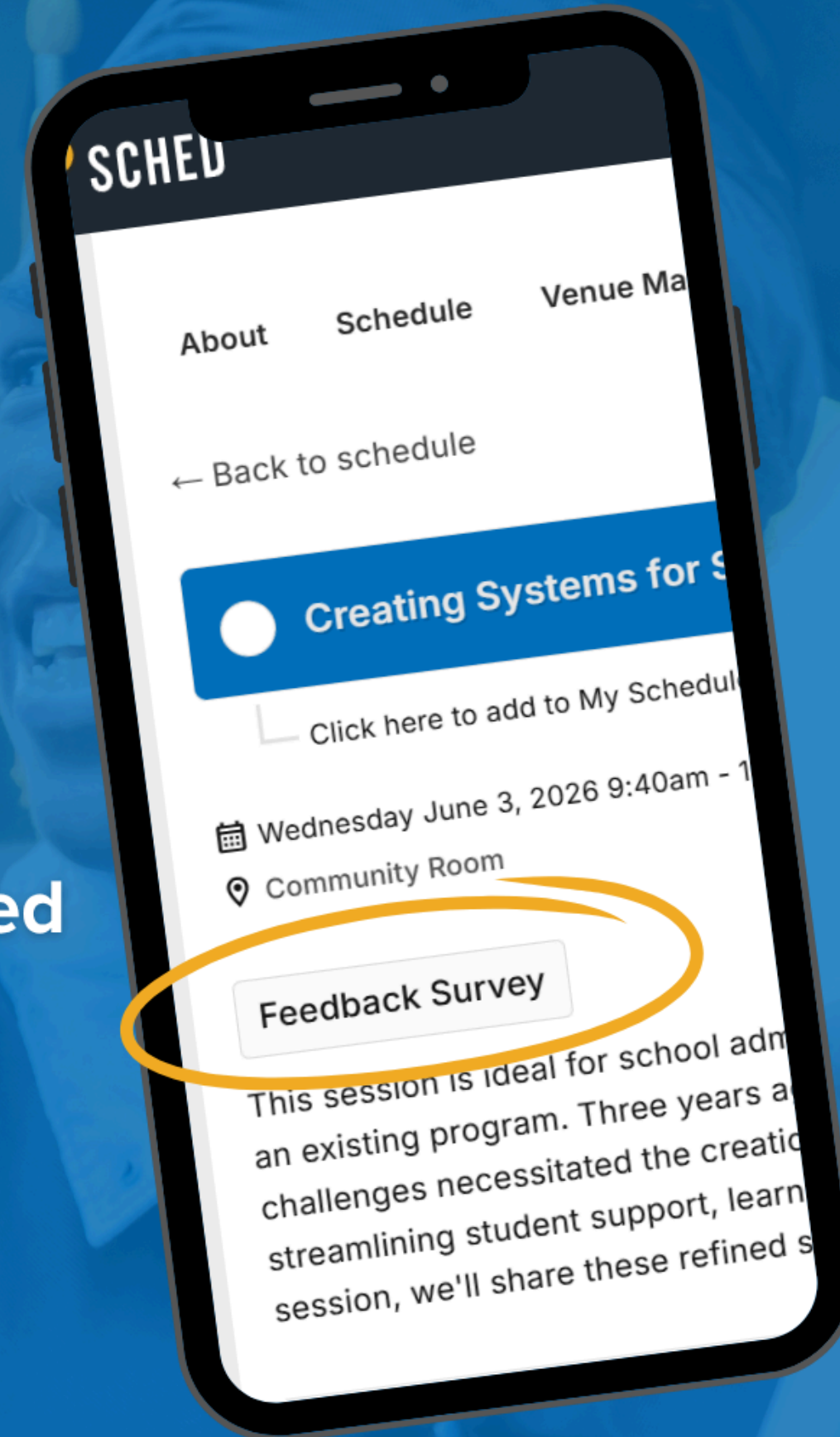

INDIANA EARLY
COLLEGE SUMMIT