



 Messaging  Voice  Directory  Analytics

AI platform for financial services



From compliant AI To Hybrid Workflow Orchestration with Fluxnova

2026

Kevin RENAUDON - Lead Product Manager

AI AGENTS: **STRENGTHS** & **WEAKNESSES**

 **STRENGTHS**

-  **Understand user intent**
via natural language processing
-  **Understand & Call appropriate tools**
-  **Natural interactions**

 **WEAKNESSES**

-  **Outputs are non deterministic**
-  **Prompts, skills, guardrails never eliminate the risk**
-  **High risk for use cases requiring compliance**

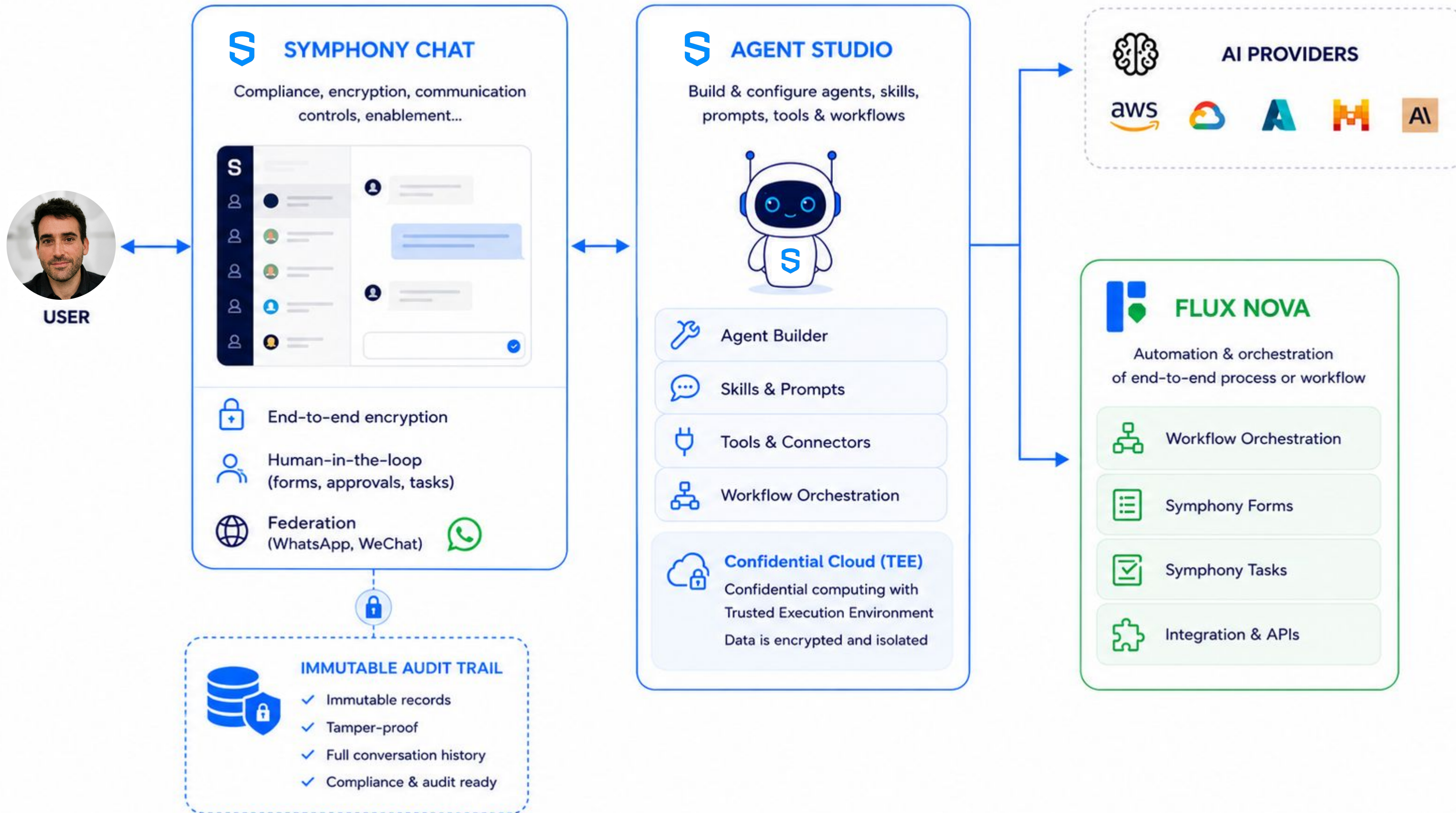



ALL CHATS

Filter chats

Filter chats

STARRED

WA | Rachel S. | Wealth ...

Market matters

Jira demo

DERIVATIVE TRADER ...

MCP DEMO

HEAD TRADER ASSIST...

RECENT

RECENT

Rachel Sonata

Room TAM demo

Maestro

test innovate 2

test-innovate

test room innovate 1

News

Jerome Folli, Tetiana Kus...

Tetiana Kushchynska

Investment recommenda...

SIGNALS AND TAGS

APPS

AI Risk Manager

AI Studio

Alien

Alien

Derivative trader a...

Enhanced Directory

WA | Rachel S. | Wealth Mgmt

Private Room · 2 People · Add members

RTE SUGGESTIONS

Explore the Help Center

Located in the help section of the settings, find how-to guides, articles, and additional resources.

Tuesday, June 09, 2026

You created this chat

You added Rachel Sonata to the chat

Rachel Sonata

10:58 AM Hey @ Kevin Renaudon , I've been reading about Private Equity yields. I want more exposure to PE to boost my portfolio's performance this year. Any ideas?

Kevin Renaudon

10:58 AM Hi @ Rachel Sonata . We just launched 'Private Equity Horizon 2032'. It targets a 12% Net IRR but requires a 10-year lock-up. The minimum ticket is \$250,000.

Rachel Sonata

10:59 AM I'm interested. Let's do it.

Message to WA | Rachel S. | Wealth Mgmt...

Activity Feed

All Chats

External

Head trader

Sales dealer

Unread only

New incoming messages will appear here

AI & WORKFLOWS ARE NOT EXCLUSIVE

BEST SOLUTIONS WILL EMERGE BY **COMBINING BOTH**



Symphony manages interactions and compliance.



AI Agents provide intelligence.



FluxNova guarantees execution.

Thank you

Questions? Please contact

Name: kevin.renaudon@symphony.com



Neither Symphony Communication Services, LLC (together with its affiliates, “Symphony”) nor the services which Symphony offers to its customers (“Symphony Services”) is subject to the oversight or jurisdiction of any financial regulatory body.

Symphony is not, and shall not be construed as, a registered broker-dealer, an underwriter of securities, an introducing broker, or an entity performing similar or other regulated functions. Similarly, Symphony is not registered as, or to be construed as, a multilateral facility (including but not limited to a SEF, MTF or OTF), trading venue, regulated market or exchange. Because Symphony does not act in these capacities, nor is Symphony registered to do so, any indication to the contrary in this document or in any other document provided to you by Symphony shall be interpreted to the maximum extent so as not to imply that Symphony is acting in such capacity (or in any other capacity that is subject to regulatory oversight or subject to a requirement to register with a financial regulator).

Any Symphony Service that permits customers to negotiate the terms of any financial instrument is offered, and only capable of being used, on a purely bilateral basis. Symphony has no role or involvement in the negotiation or arranging of any transactions in financial instruments nor in the introduction of counterparties to one another for purposes of entering into such transactions. The execution of any such transaction is solely as between the counterparties thereto, and Symphony does not perform any execution, clearing or settlement function for any financial instrument transaction. To the extent that any Symphony customer utilizes Symphony Services for purposes of negotiating financial instruments, it is solely the responsibility of such customer to comply with any regulatory requirements to which such customer, or such negotiation, may be subject.

Neither this document, nor the offering by Symphony, or use by any Symphony customer, of any Symphony Service, shall be construed as a solicitation, endorsement, offer or recommendation by Symphony to buy, sell or hold any financial instrument, or an offer to provide any investment advice or investment services to any person in any jurisdiction. Recipients of this document and users of all Symphony Services alone assume the responsibility of evaluating the merits and the risks associated with the use of the Symphony Services.

Symphony is not a provider of call bridging services or any other regulated telecommunications functionality, and Symphony serves solely as a sales agent or network manager, and not as a “reseller,” in facilitating use of any regulated functions. Symphony is not responsible for originating PSTN voice calls from, and terminating calls to, users on its platform, and such functionality is provided by third-party service providers.

Furthermore, certain of the statements and terms contained in this document may be forward-looking and contain concepts, product ideas or functionalities that are not currently part of the Symphony Service suite, but are instead contemplated by Symphony to be offered to customers at a future date. There is no guarantee that any such functionality will be offered by Symphony, and until such time, if any, as a particular functionality is included in the Symphony Services pursuant to a contractual agreement between Symphony and the customer utilizing such functionality, the depiction of such concepts, ideas and functionalities shall be construed as forward-looking only.

Nothing in this document or in the license or operation of any Symphony Service constitutes a representation by Symphony that is contrary to the foregoing disclaimers.